

1 Assembling the Body

First, assemble each component by following the working method and markings. Then, refer to the illustration and photos below to glue the parts together.

Indication of Working Methods

▄▄▄▶ Fold or Curve ▶ Glue

Body

Sheet A, 1 part in total

Fold each relevant part according to the assembly symbols.

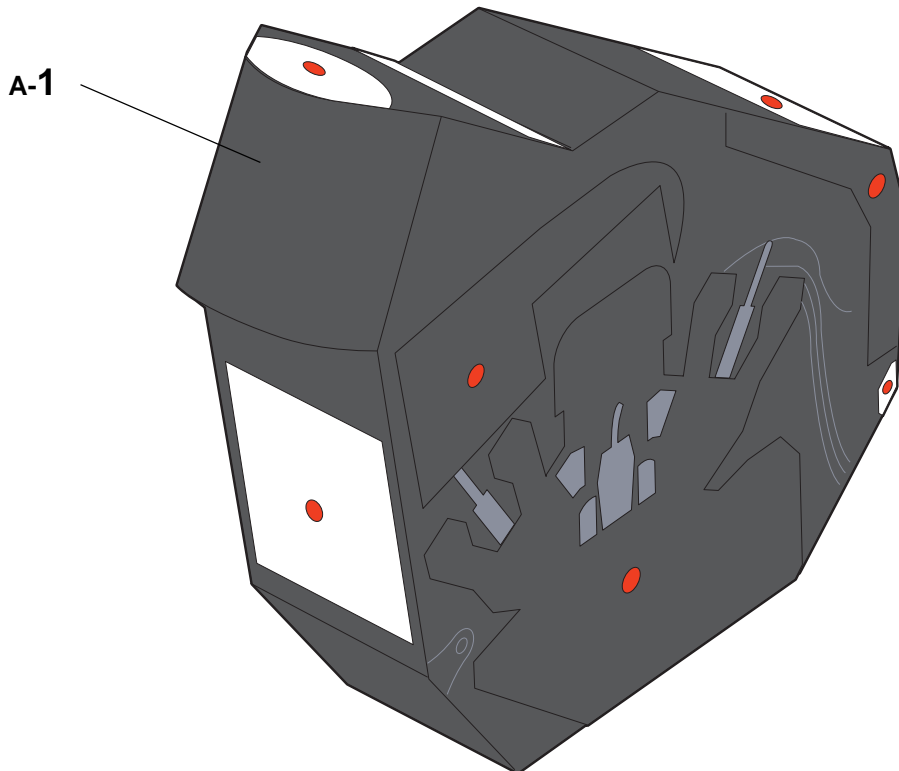

Reference photo



2 Assembling the Steering Column

First, assemble each component by following the working method and markings. Then, refer to the illustration and photos below to glue the parts together.

Indication of Working Methods



Fold or Curve



Glue

Steering column

Sheet B, 24 parts in total

Fold each relevant part according to the assembly symbols.

Please use the ● dots on each component as reference when gluing surfaces.

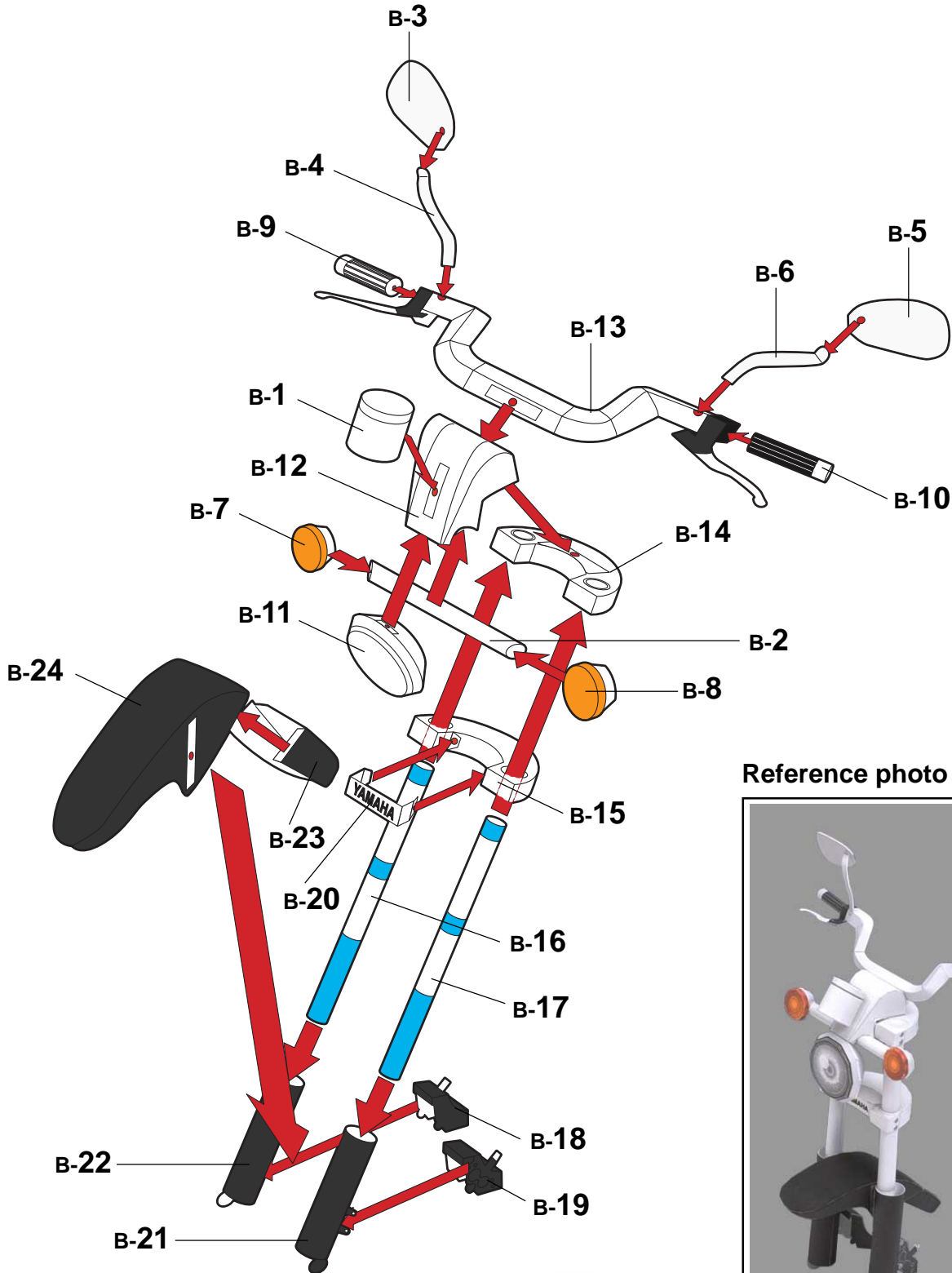

Apply glue on the ■ area indicated in the illustration.

Reference photo



3 Assembling the Top Cover and Intake

First, assemble each component by following the working method and markings. Then, refer to the illustration and photos below to glue the parts together.

Indication of Working Methods



Fold or Curve



Glue

Top cover

Sheet C, 2 parts in total

Fold each relevant part according to the assembly symbols.

Please use the ● dots on each component as reference when gluing surfaces.

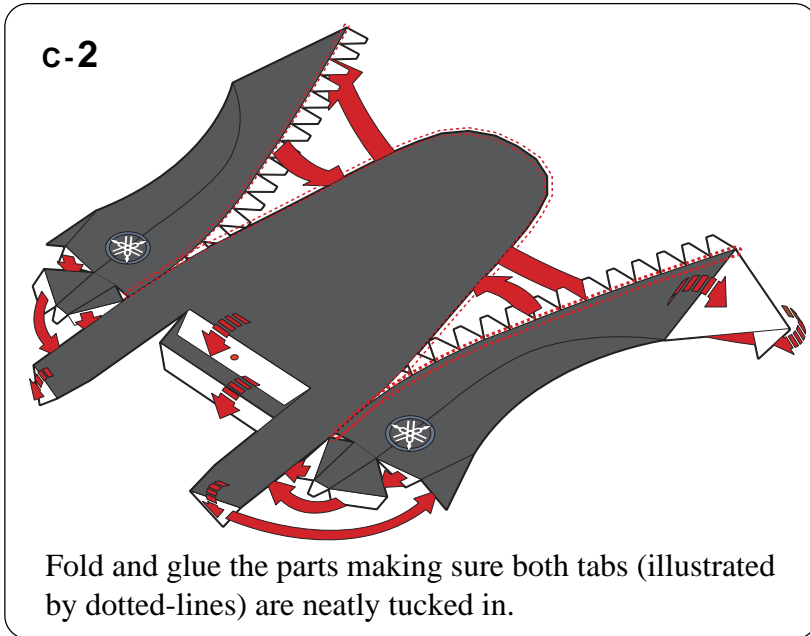
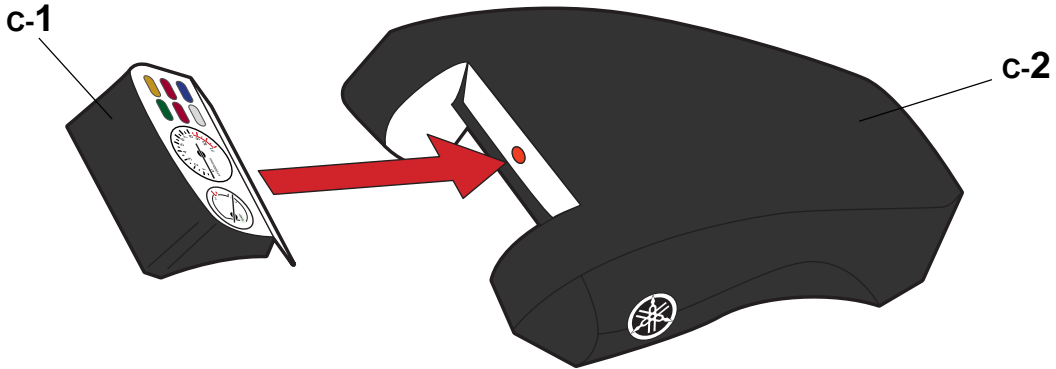

Reference photo



Intake

Sheet D, 2 parts in total

Fold each relevant part according to the assembly symbols.

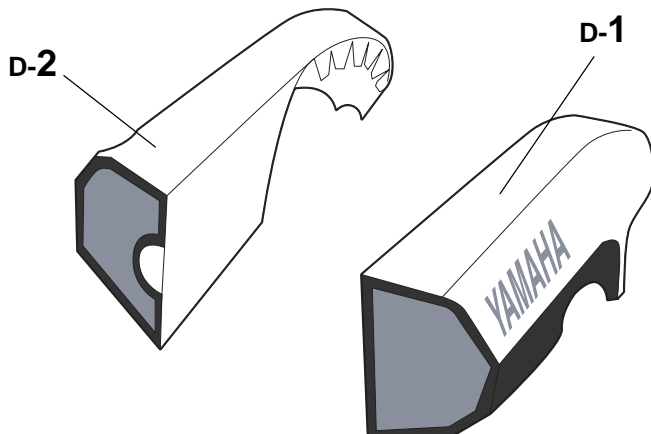

Reference photo

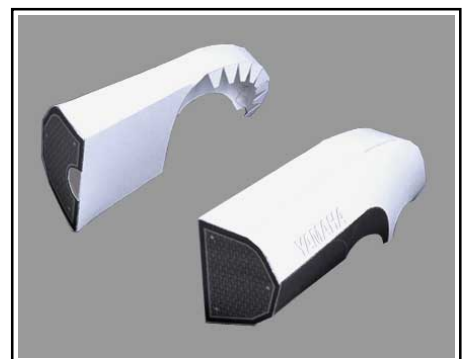

4 Assembling the Engine

First, assemble each component by following the working method and markings. Then, refer to the illustration and photos below to glue the parts together.

Indication of Working Methods



Fold or Curve



Glue

Engine

Sheet E, 47 parts in total

Fold each relevant part according to the assembly symbols.

Please use the ● dots on each component as reference when gluing surfaces.

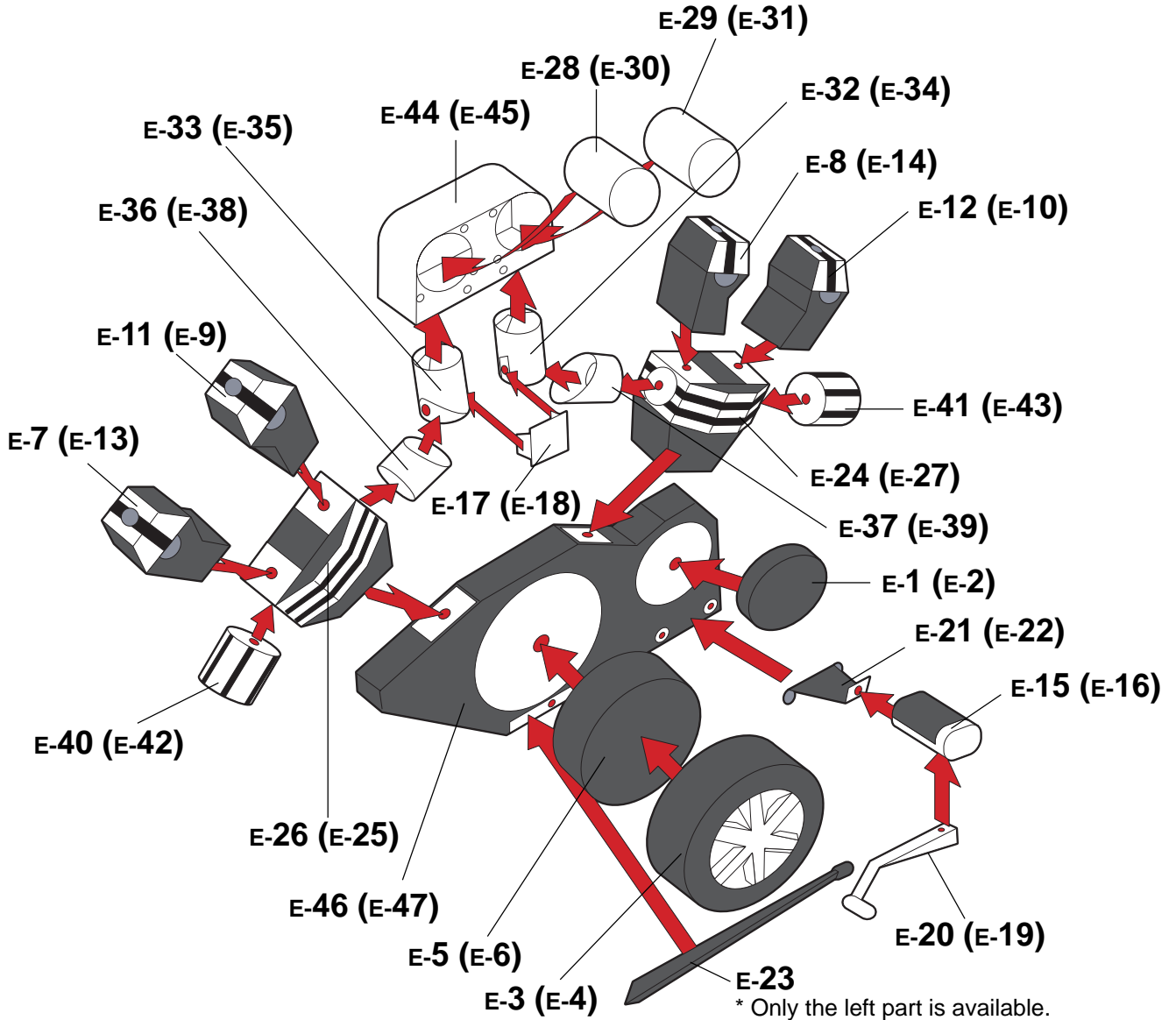

Reference photo

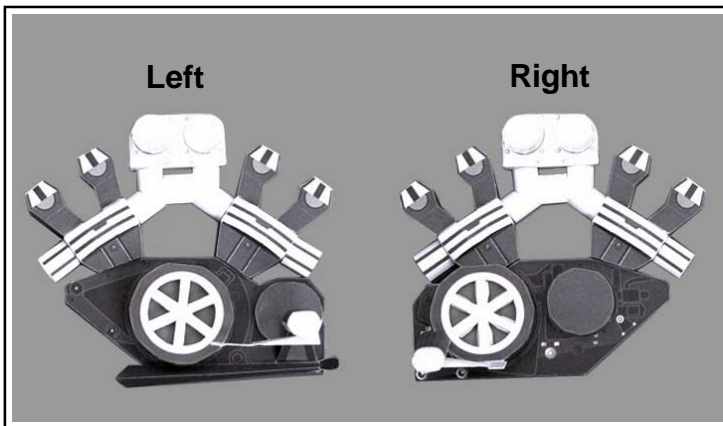

* Make two of each part.

The diagram shows how the left part of the engine looks. The numbers within parentheses indicate parts for the right part of the engine.

5 Assembling the Side Covers

First, assemble each component by following the working method and markings. Then, refer to the illustration and photos below to glue the parts together.

Indication of Working Methods



Fold or Curve



Glue

Side covers

Sheet F, 20 parts in total

Fold each relevant part according to the assembly symbols.

Please use the ● dots on each component as reference when gluing surfaces.

*** Make two of each part.**

The diagram shows how the left frame cover looks. The numbers within the parentheses indicate parts for the right frame cover.

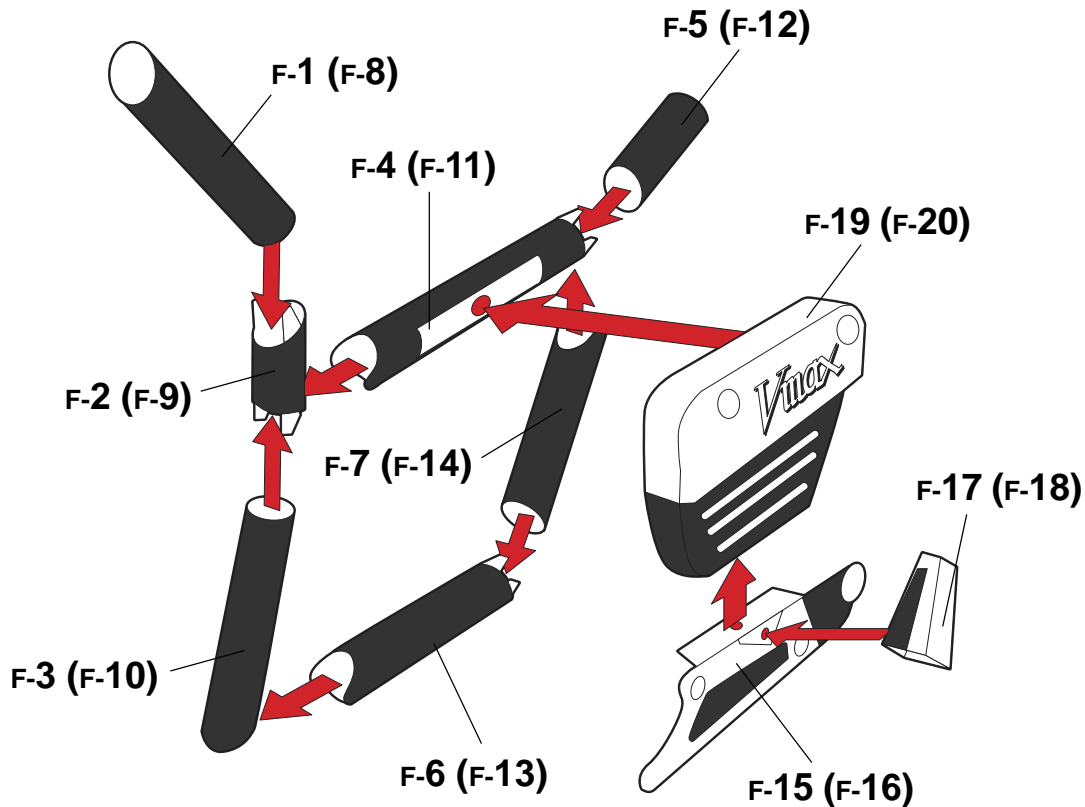

Reference photo

