

6 Assembling the Exhaust

First, assemble each component by following the working method and markings. Then, refer to the illustration and photos below to glue the parts together.

Indication of Working Methods



Fold or Curve



Glue

Exhaust

Sheet G, 23 parts in total

Fold each relevant part according to the assembly symbols.

Please use the ● dots on each component as reference when gluing surfaces.

➡ in the diagram indicate where parts are to be glued later.
Please do not glue parts at this stage.

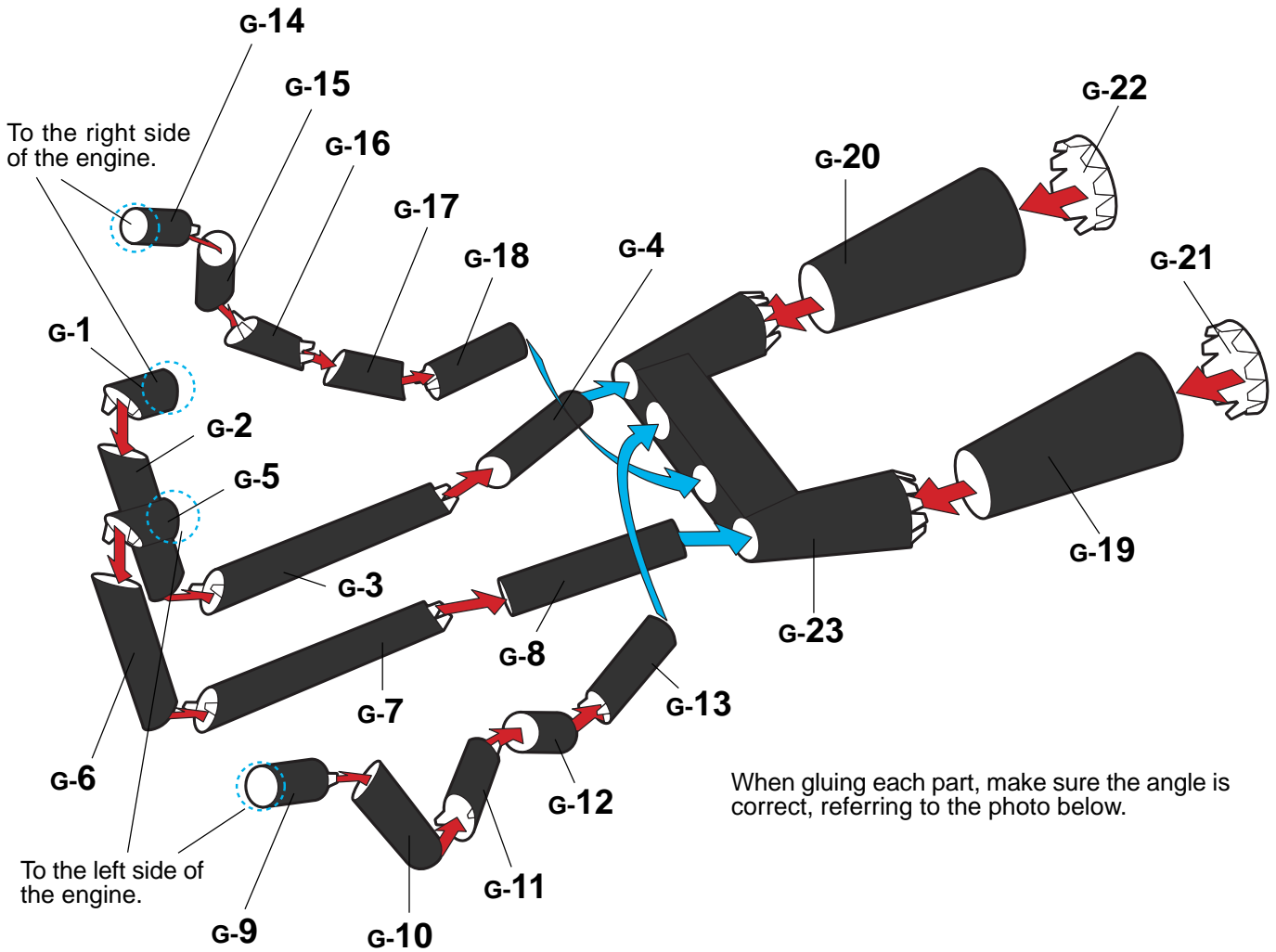

When gluing each part, make sure the angle is correct, referring to the photo below.

Reference photo

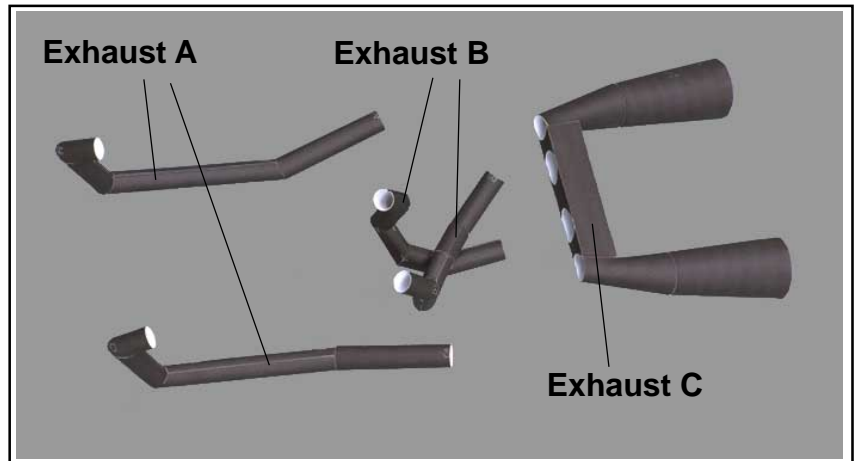

Partition of exhaust pipes

- Exhaust A (Right) G-1 to G-4
- Exhaust A (Left) G-5 to G-8
- Exhaust B (Right) G-14 to G-18
- Exhaust B (Left) G-9 to G-13
- Exhaust pipe C G-19 to G-23

7 Assembling the Radiator and Rear Suspensions

First, assemble each component by following the working method and markings. Then, refer to the illustration and photos below to glue the parts together.

Indication of Working Methods



Fold or Curve



Glue

Radiator

Sheet H, 3 parts in total

Fold each relevant part according to the assembly symbols.

Please use the ● dots on each component as reference when gluing surfaces.

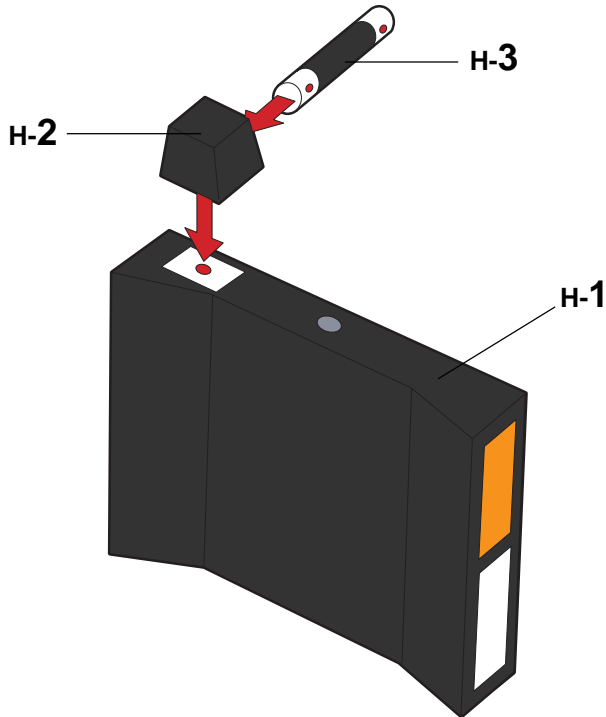

Reference photo

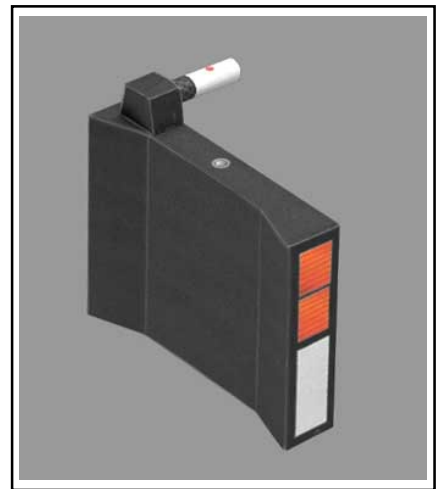

Rear suspensions

Sheet I, 8 parts in total

Fold each relevant part according to the assembly symbols.

Please use the ● dots on each component as reference when gluing surfaces.

* Make two of the rear suspensions. They should be identical. The numbers within the parentheses indicate the parts for the second suspension.

Reference photo

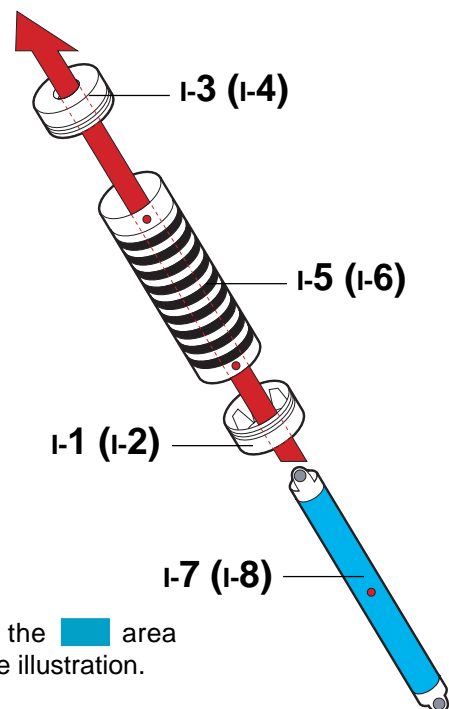
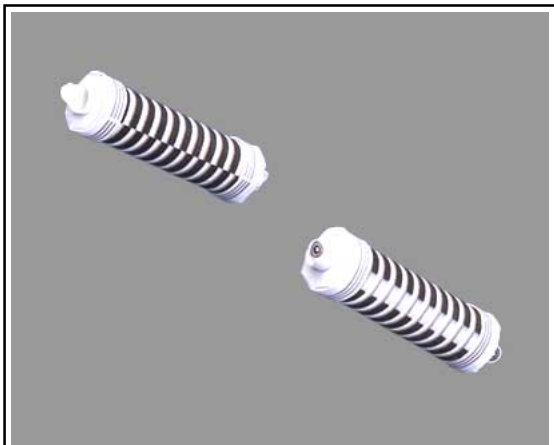

Apply glue on the ■ area indicated in the illustration.

8 Assembling the Rear Fender and Seat

First, assemble each component by following the working method and markings. Then, refer to the illustration and photos below to glue the parts together.

Indication of Working Methods

 Fold or Curve  Glue

Rear fender

Sheet J, 3 parts in total

Fold each relevant part according to the assembly symbols.

Please use the ● dots on each component as reference when gluing surfaces.

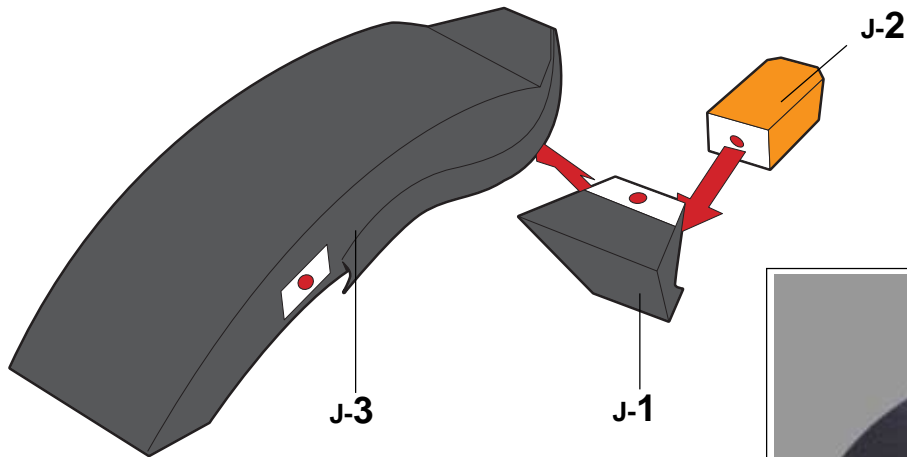

Reference photo



Seat

Sheet K, 9 parts in total

Fold each relevant part according to the assembly symbols.

Please use the ● dots on each component as reference when gluing surfaces.

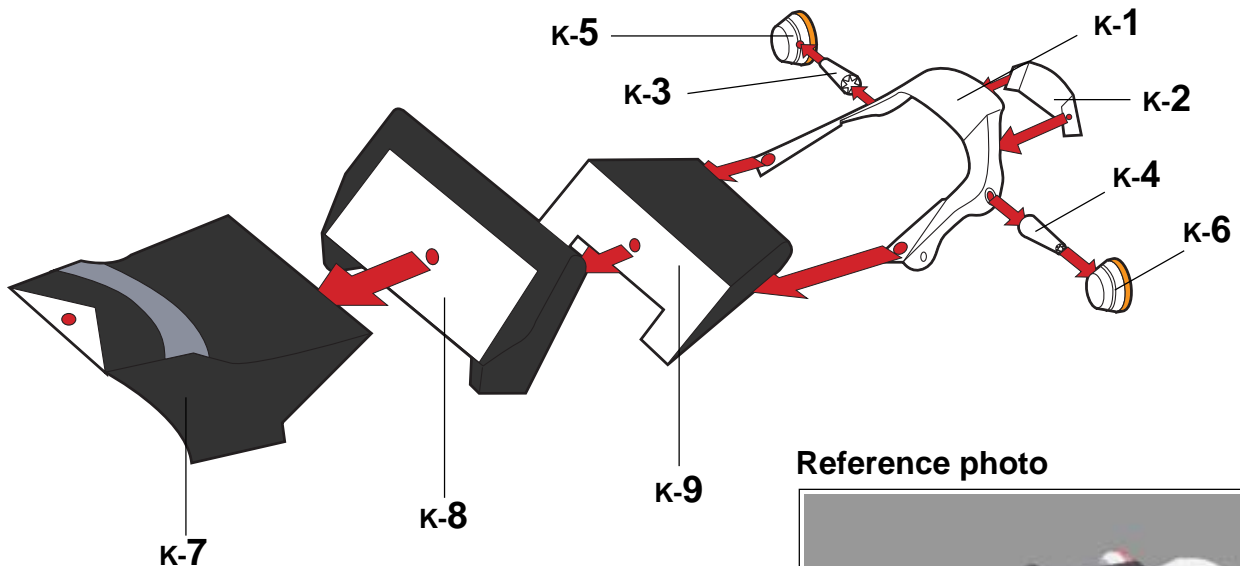

Reference photo



9 Assembling the Front Tire

First, assemble each component by following the working method and markings. Then, refer to the illustration and photos below to glue the parts together.

Indication of Working Methods



Fold or Curve



Glue

Front tire

Sheet L, 13 parts in total

Fold each relevant part according to the assembly symbols.

Please use the ● dots on each component as reference when gluing surfaces.

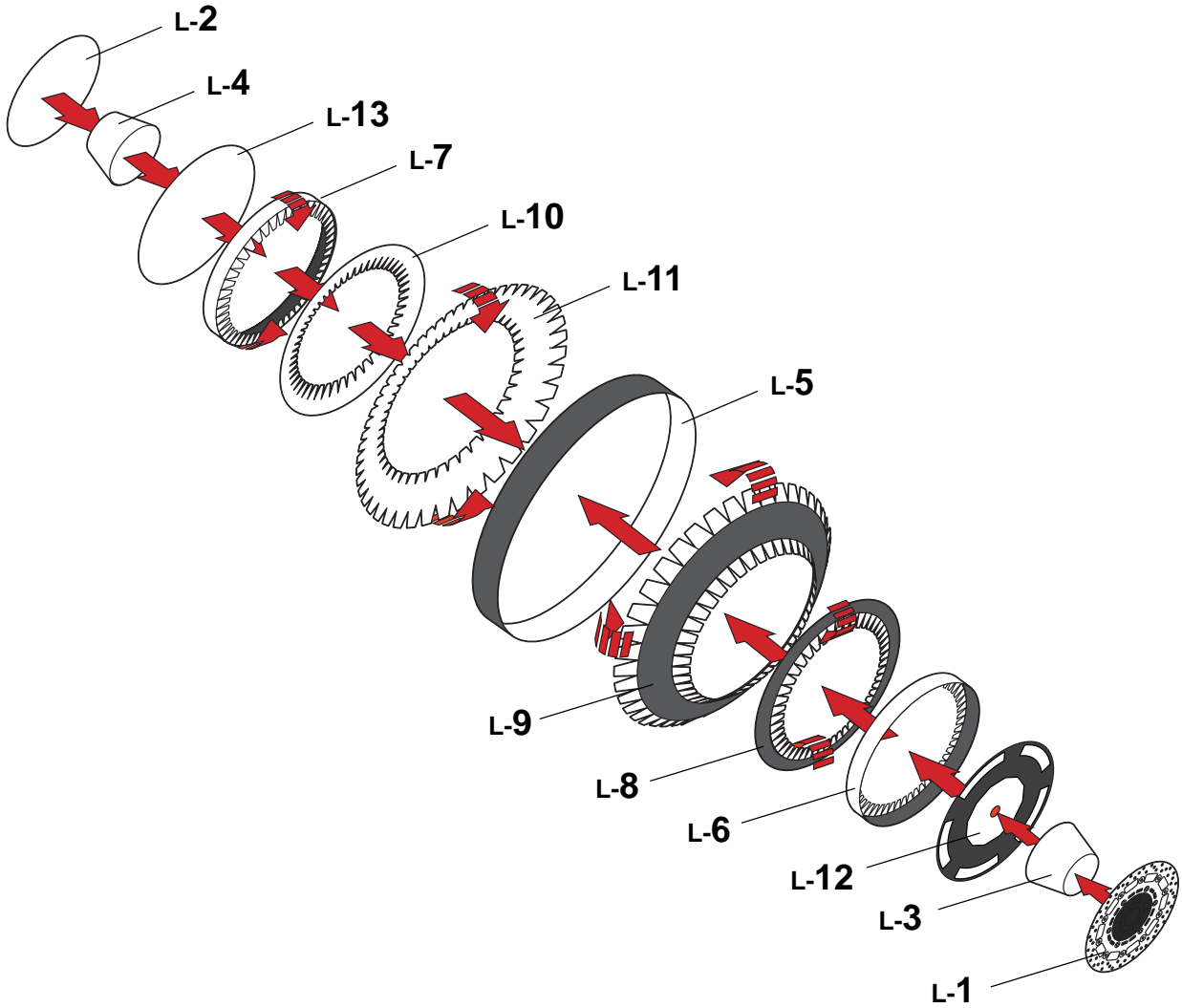

Reference photo

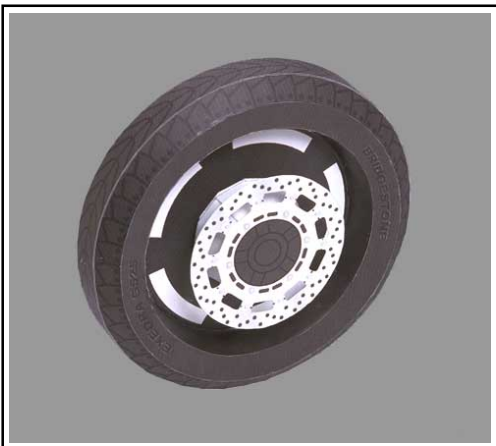

10 Assembling the Rear Tire

First, assemble each component by following the working method and markings. Then, refer to the illustration and photos below to glue the parts together.

Indication of Working Methods



Fold or Curve



Glue

Rear tire

Sheet M, 19 parts in total

Fold each relevant part according to the assembly symbols.

Please use the ● dots on each component as reference when gluing surfaces.

*Glue the completed rear arm to the assembled rear tire.

Reference photo



[Rear tire]

